



Wishbone  
site furnishings

# OUTHOUSE BUILDINGS

WHEN  
NATURE  
CALLS ...



# ... WISHBONE ANSWERS

Since inception in 1995, Wishbone Site Furnishings has become an industry leader in sustainably designed commercial furniture. Based in Vancouver, Canada, Wishbone designs and locally manufactures innovative and functional site furnishings with high recycled content, requiring little or no maintenance.

Drawing from this broad background, Wishbone extends its design and manufacturing expertise to enhancing outdoor sanitation with outhouse buildings that benefit from the unique advantages of 100% recycled plastic boards and marine grade aluminum frames. While this may not sound very glamorous, you'll understand if you're in the vicinity of a Wishbone outhouse when nature calls.



Find out more online  
[WishboneLtd.com/outhouse](http://WishboneLtd.com/outhouse)



JOHN JANSEN,  
PRESIDENT



# JOHN OUTHOUSE BUILDING

Find out more online  
[WishboneLtd.com/john](http://WishboneLtd.com/john)



The John Outhouse Building represents a commercial grade contemporary version of a classic design, offering natural illumination and a comfortable user experience. Available in multiple sizes, the John is the perfect choice for a low-maintenance restroom building that is easy to install in challenging-to-service or backcountry locations.

- A traditional standalone outhouse look with a clear peaked roof
- A durable structure with recycled plastic planks supported by a powder coated aluminum frame
- Easy to deliver and install almost anywhere
- Designed for low-maintenance in diverse environments



JOHN REGULAR [48" W x 55" D]



JOHN ADA COMPLIANT [68" W x 80" D]  
JOHN JUMBO [68" W x 68" D]



# FOREST OUTHOUSE BUILDING

Find out more online  
[WishboneLtd.com/forest](http://WishboneLtd.com/forest)



The Forest Outhouse Building incorporates a clear slanted roof design that allows for multiple units in a row. Several building sizes are available, each offering ample natural light and a pleasant user experience. The Forest is the optimal choice for a durable, low-maintenance restroom solution in remote or hard-to-service areas.

- A clear slanted roof allows for multiple consecutive units or standalone placement
- A durable structure with recycled plastic planks supported by a powder coated aluminum frame
- Easy to deliver and install almost anywhere
- Designed for low-maintenance in diverse environments



FOREST REGULAR [48" W x 55" D]



FOREST ADA COMPLIANT [68" W x 80" D]  
FOREST JUMBO [68" W x 68" D]



FOREST DOUBLE [96" W x 55" D]





# EASY ASSEMBLY

Each Wishbone outhouse building is shipped on a pallet, standardizing delivery and simplifying handling. For remote back country installation, helicopters, horses, ATVs, and boats have been used to deliver a building to its designated site.

The assembly process is intentionally straightforward. With just basic hand tools, two individuals can put together an outhouse building in 3 to 4 hours.

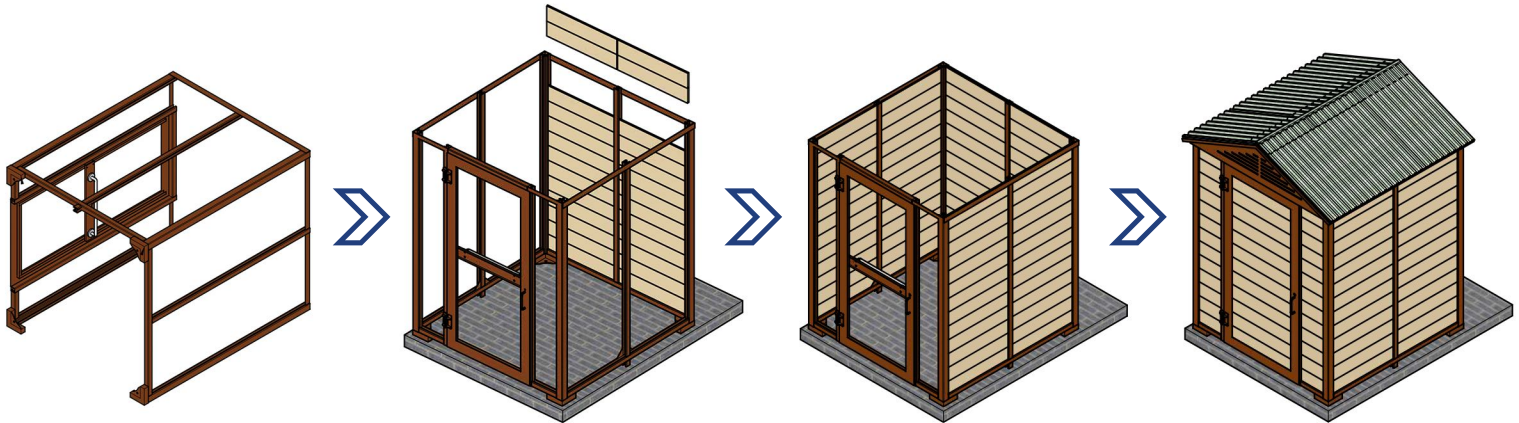



# OPTIONS

Wishbone outhouse buildings can be customized to meet unique requirements. For example, the Forest configuration shown on the adjacent page includes a storage room with a steel door. Other choices could include a high snow load roof or the options shown here.



## ◀ TOILET RISER

ADA compliant 18”  
or standard 14”  
toilet seat

## OUTHOUSE EXTENSION ▶

For use with behind the wall  
urine-diverting toilet systems



## FOLD-DOWN SEAT ▲

A convenience seat for our Jumbo  
or ADA Compliant models

## VENT STACK ▶

6” ABS plastic pipe  
for venting the  
concrete vault



## ◀ ALUMINUM FLOOR

A durable alternative base  
to concrete or wood

# RECYCLED PLASTIC

Our 100% recycled plastic boards are made entirely from waste plastic such as plastic bags, drinking straws, milk jugs and industrial plastic waste. Not only does this keep plastic out of the environment, but the resulting boards are ideal for outhouse buildings. They are extremely durable in all environments. Some of our recycled boards have been in service for 25+ years, and they still look great and function like new. If recycled plastic boards do need to be replaced, they are fully recyclable.



Find out more about  
Wishbone sustainability  
[WishboneLtd.com/recycle](http://WishboneLtd.com/recycle)



**3.6 MILLION LBS.  
OF WASTE PLASTIC REUSED  
IN THE LAST DECADE**



BLACK



GREY



REDWOOD



SAND



WALNUT

# POWDER COATED ALUMINUM

Our robust marine grade aluminum outhouse structures, designed for challenging outdoor conditions, feature an industry-leading 5-stage super-durable powder coating. Available in a wide range of standard colours, this coating also protects against corrosion. Custom RAL colours are available on request.



TEXTURED SILVER



GREY GOLD



NORDIC LICHEN



GROOVY RED



BROWN SLATE



PRECIOUS SAND



MODERN KHAKI



FLAME RED



OIL RUBBED  
BRONZE



EARTH CLAY



YELLOW GREEN



PASTEL ORANGE



VICTOR RIDGE II



NOBLE BRONZE



WATER BLUE



TRAFFIC YELLOW



BLACK TEXTURED



TIMELESS RUST



ULTRAMARINE  
BLUE



SIGNAL VIOLET

# MANUFACTURING

Wishbone is proud to manufacture outhouse buildings in BC, utilizing advanced technology for construction and materials. Our commitment to surpassing industry standards, combined with the expertise of our skilled craftsmen, ensures that each component not only fulfills its intended purpose but consistently exceeds expectations in quality and durability.



# INTENTIONAL DESIGN

Wishbone considers all stakeholders involved and purposefully designs its products to have a positive experience for each one.



## ASSEMBLERS

The assembly package is portable and relatively quick and easy to install, even in remote locations.



## MAINTAINERS

Damaged components can often simply be replaced.



## CLEANERS

Recycled plastic does not absorb moisture, enabling power washing or chemical disinfection.



## USERS

The bright and comfortable outhouse building does not absorb smells.



WISHBONE PRODUCTS  
ARE BACKED WITH  
ONE OF THE BEST  
WARRANTIES  
AVAILABLE

## 10 YEARS

- Limited warranty on all recycled plastic against rotting, splitting, cracking, or splintering.
- Limited warranty on all frames against structural failure under normal use.

## 5 YEARS

- Limited warranty on all products for workmanship and/or manufacturing defects.



BENCHES  
CHAIRS  
PLANTERS  
BOLLARDS  
BIKE RACKS  
PICNIC TABLES  
RECYCLING STATIONS  
WASTE RECEPTACLES  
OUTHOUSE BUILDINGS

Wishbone  
site furnishings

#210-27090 Gloucester Way | Langley, BC | Canada | V4W 3Y5  
Sales@WishboneLtd.com | WishboneLtd.com  
604.626.0476 | Toll Free 866.626.0476

V10024

